





- LOQUINTA PARTER PROPUSA -

Aria construita	Aria desfasurata	Aria utila	H coama	H streasina
81,34 mp	81,34 mp	65,71 mp	4,83 mp	2,70 mp

POT existent	CUT existent
2,67 %	0,02

POT propus	CUT propus
4,03 %	0,04

LEGENDA

-  Corp cladire propusa PARTER NC 74836
-  Trotuare perimetrale
-  Spatii verzi, gazon si arbusti ornamentali
-  Limita proprietate
-  Cladire existenta- 74836-C1 Loc. Budu Cantemir, Jud. Vaslui - CRAMA AN EDIF CONSTR 2023

S teren = 5.961 mp, determinati topometric

572700

Punct inceput	Punct sfarsit	Lungime segment(“(m)
1	2	33.123
2	3	1.8
3	4	22.385
4	5	4.578
5	6	19.006
6	7	21.234
7	8	62.349
8	9	21.177
9	10	19.007
10	11	22.399
11	12	32.018
12	1	61.559

- Lungimile segmentelor sunt determinate în planul de proiectie Stereo 70 și sunt rotunjite la 1 milimetru.
- Distanța dintre puncte este formată din segmente cumulate ce sunt mai mici decât valoarea 1 milimetru.

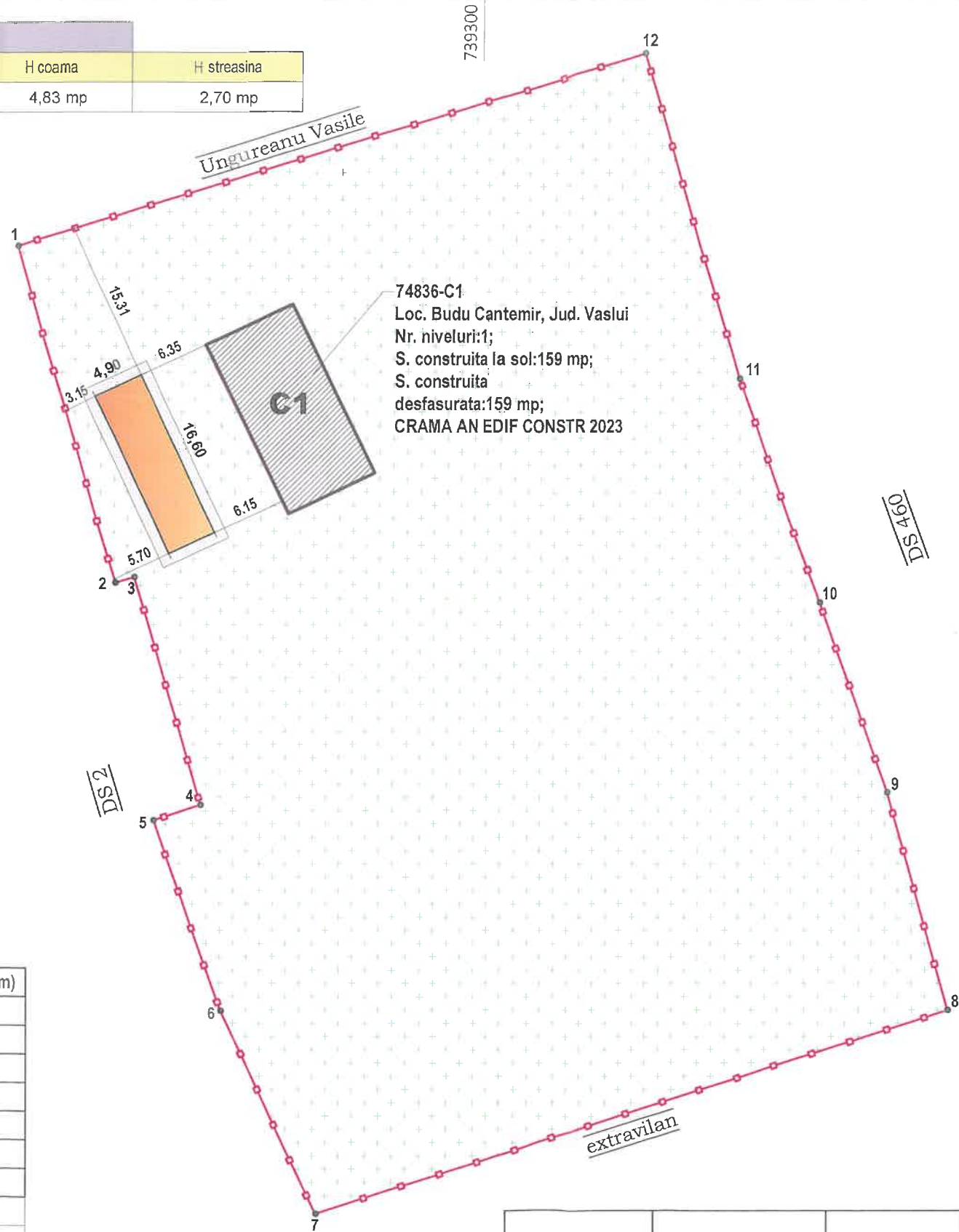

74836-C1
 Loc. Budu Cantemir, Jud. Vaslui
 Nr. niveluri:1;
 S. construita la sol:159 mp;
 S. construita desfasurata:159 mp;
 CRAMA AN EDIF CONSTR 2023

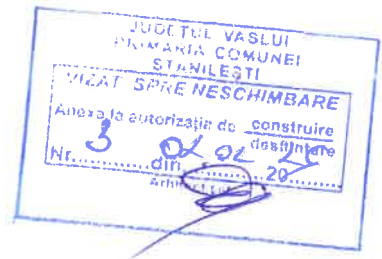

- CATEGORIA DE IMPORTANTA: "D"
 (conform HG 766/1997)
 - CLASA DE IMPORTANTA: "IV"
 (conform P100/2013)
 - GRAD DE REZISTENTA LA FOC: "IV"
 (conform P118/1999)
ag=0,25g; Tc=0,70s

Verificator	Nume/Prenume	Semnatura	Cerinta	Referat / Expertiza nr. / data
 S.C.DECO PROIECTARE S.R.L. Str. Stefan cel Mare, Nr.272, Vaslui J371467/2019 CUI: 41052759 E-mail: bogdan.3690@gmail.com Tel: 0743 789				Beneficiar: STREIT MARIANNE Proiect nr. 77/2025
	Adresa: KÖNIG BE, ELVETIA, HEITIWI 24, 3186 DÜDINGEN			Amplasament: Sat Budu Cantemir, Comuna Stănițești, Județul Vaslui, N.C.74836
	Scara: 1:500			Titlu plansa: PLAN DE SITUATIE
	DESENAT: ing. Bogdan Popa	PROIECTAT: Arh. Hanganu Nicolae	Data: 2025	Faza D.T.A.C. Plansa A-02